



Style P Sight Glass

This straight through sight glass is ideal for you to visually check the presence, colour and condition of a liquid.

- ◆ High quality robust design
- ◆ CE marked and fully PED compliant
- ◆ Pressures up to 60 bar
- ◆ Temperatures up to 250°C
- ◆ Short lead times
- ◆ The lowest prices in the UK
- ◆ Designed and manufactured in the UK.



Application

The style P sight glass has a plain spout cast in the body and is used to check for the presence of a liquid where there is intermittent flow, partially filled lines or entrained air. It can be used in vertical or horizontal lines. The integral drip lip makes it ideal for leak detection.

Construction

The bodies are cast in either carbon steel or 316 stainless steel.

The glass windows are held in place by stainless steel covers and screws, and sealed with PTFE gaskets, giving superior protection. For ease of maintenance the glasses can be individually removed and replaced.

For standard applications the indicator is fitted with toughened soda lime glass discs to BS3463 and rated to 16 bar. For steam and condensate we recommend toughened borosilicate glass, while for alkaline liquids mica discs can be used to protect the glass.

The sight glasses can be supplied with screwed connections to NPT, BSP parallel or taper. The standard flanges available are ANSI 150, ANSI 300 and PN16, though special flanges can be supplied.

Options

Body - Primary Flowpoints can supply sight glasses in special materials such as super duplex or low carbon steels. Sight glasses conforming to NACE MR0175 can be produced. For particularly corrosive applications the body can be lined with HALAR, ECTFE or PFA.

Glass - High pressure toughened soda lime to BS3463 rated to 60 bar, toughened borosilicate to BS3463 or DIN7080 rated up to 16 bar. The high pressure range uses powder coated mild steel covers as standard, though stainless steel covers are available..

Output - A flow switch can be fitted to the indicator to give an alarm if the flow moves above or below a preset value.

Quality

All flowpoints indicators are manufactured to the highest standards.

The quality system is independently audited by BSI and certified to ISO 9000. The indicators are fully PED compliant and CE marked where required. TUV are our external auditors for the Pressure Equipment Directive.

Full material traceability is maintained, material certificates and pressure test certificates are supplied on request.

Specification Code

| Code | | Description |
|------|----------------|--|
| SP | | Stainless steel body BS 1504 316 C16 |
| CP | | Carbon steel body BS 1504 161 GR480 |
| H | | Glass Material & Pressure Range |
| B | | Toughened soda lime glass to BS3463 rated to 16 bar (Standard) |
| HB | | Toughened soda lime glass to BS3463 rated to 40 bar |
| | | Toughened borosilicate glass to BS3463 |
| | | Toughened borosilicate glass to DIN 7080 |
| | Indicator Size | |
| | 015 | 15mm / ½" |
| | 020 | 20mm / ¾" |
| | 025 | 25mm / 1" |
| | 040 | 40mm / 1 ½" |
| | 050 | 50mm / 2" |
| | 080 | 80mm / 3" |
| | 100 | 100mm / 4" |
| | 150 | 150mm / 6" |
| | 200 | 200mm / 8" |
| | End Connection | |
| | A | ANSI 150 |
| | C | ANSI 300 |
| | N | PN16 |
| | 1 | BSP |
| | 2 | BSPT |
| | 3 | NPT |
| | 4 | Socket Weld |

Materials of Construction

Covers (Standard) - Stainless steel BS 1504 304 C15

(High Pressure) - Powder coated mild steel

Internal Gasket - PTFE

External Gasket - Klingersil C4400

Edge Protector - Klingersil C4400

Fasteners (Standard) - A2 Stainless steel

(High Pressure) - High tensile steel

Dimensions

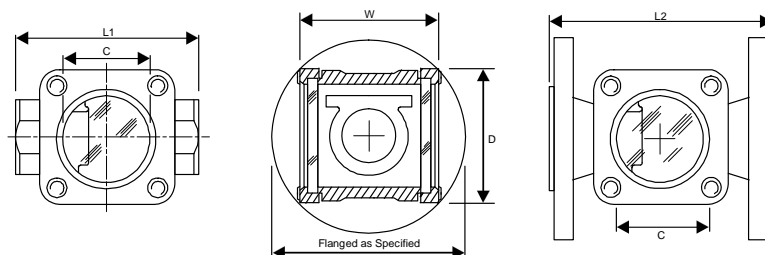

| NOMINAL BORE | LENGTH L1 | LENGTH L2 | WIDTH W | DEPTH D | CLEARVIEW C |
|--------------|-----------|-----------|---------|---------|-------------|
| 15/20mm | 85 | 130 | 63 | 60 | 42 |
| 25mm | 95 | 140 | 72 | 66 | 48 |
| 40mm | 120 | 180 | 102 | 84 | 62 |
| 50mm | 150 | 220 | 118 | 106 | 77 |
| 80mm | N/A | 260 | 160 | 170 | 100 |
| 100mm | N/A | 260 | 196 | 170 | 100 |
| 150mm | N/A | 360 | 304 | 220 | 150 |
| 200mm | N/A | 460 | 370 | 280 | 200 |